



10th Biennial Meeting

Creativity, Spirituality, and Health
Across the Life-Span

October 6-8, 2017



OMNI  HOTELS & RESORTS
providence | rhode island

Table of Contents

Conference Chair

David Henry Feldman, Tufts University

Program Chair

Joseph Fitzgerald, Wayne State University

General Schedule

Friday, October 6 th - Morning.....	3
Friday, October 6 th - Afternoon.....	4
Saturday, October 7 th - Morning.....	5
Saturday, October 7 th - Afternoon.....	6
Sunday, October 8 th – Morning	7
Sunday, October 8 th - Afternoon.....	8
SSHD Officers and Committees.....	9-10
Accommodations.....	11
Omni Hotel Conference Floor Plan.....	12
Keynote Addresses.....	13-17
1) Spirituality and Health: Half a Million Studies and Still So Much to Learn!	
2) Mod Squad for Youth Mental Health: Synthesizing Evidence-Based Interventions for Children and Adolescents	
3) Creativity is a Decision	
4) Social Relations, Culture, Character Development and Health	
5) Spirituality and Thriving: Contemporary Investigations	
Invited Plenary Symposia.....	18-20
A) Reviewing what we may miss: Exploring regularities and variations in religion and spirituality across developmental processes, contexts, and outcomes, Mona Abo-Zena, Organizer	
B) The Human-Nature Connection, George Scarlett, Organizer	
C) The Developmental Transition from Discrete Memories to an Integrated, Creative Web of Understandings, Liane Gabora, Organizer	
Symposia (1-12).....	21-32
Poster Sessions (1 & 2).....	33-38
Author Index.....	39-46



General Schedule

FRIDAY, OCTOBER 6th – Morning

Time	Event	Room
8:00 am -	Registration (Coffee and Tea)	Providence Foyer
9:00 - 9:15 am	President's Welcome	Providence Ballroom
9:15 - 10:30 am	Keynote Address 1: Spirituality and Health: Half a Million Studies and Still So Much to Learn! Crystal Park, University of Connecticut	Providence Ballroom
10:30 - 10:45 am	Break (Coffee, Tea and Pastries)	South County
10:45 - 12:15 pm	Plenary Symposium A: Reviewing what we may miss: Exploring regularities and variations in religion and spirituality across developmental processes, contexts, and outcomes Organized by Mona Abo-Zena, University of Massachusetts/Boston	Providence Ballroom
12:15 - 1:30 pm	Lunch Break	
12:30 - 1:30 pm	Emerging Scholars Informational and Networking Lunch	South County

FRIDAY, OCTOBER 6th – Afternoon

1:30 - 2:45 pm	<p>Concurrent Symposia</p> <p>Symposium 1: Executive Function Across the Life-Span Organized by Megan McClelland, Oregon State University</p> <p>Symposium 2: Religiosity, Spirituality, and Wisdom over the Life-Span Organized by Merrill Silverstein, Syracuse University Co-organizer Monika Ardelt, University of Florida</p> <p>Symposium 3: Intra-individual Development Over Time: A Focus on Fathers and Families Organized by Toni Antonucci, University of Michigan</p>	<p>Bristol/Kent</p> <p>Newport/Washington</p> <p>Providence Ballroom</p>
2:45 - 3:00 pm	Break	South County
3:00 - 4:15 pm	<p>Keynote Address 2: Mod Squad for Youth Mental Health: Synthesizing Evidence-Based Interventions for Children and Adolescents John Weisz, Harvard University</p>	Providence Ballroom
4:15 - 5:45 pm	<p>Poster Session 1 (Cash Bar) Chris Napolitano, Chair</p>	Waterplace Ballroom
5:45 - 6:30 pm	Break	South County
6:30 - 7:30 pm	President's Reception (Hors d'oeuvres and Cash Bar)	Waterplace Ballroom
8:00 pm	Emerging Scholar Dinner	Massimo Restaurant

SATURDAY, OCTOBER 7th – Morning

Time	Event	Room
8:00 am -	Registration	Providence Foyer
9:00 - 10:15 am	Keynote 3: Creativity is a Decision Robert J. Sternberg, Cornell University	Providence Ballroom
10:15 - 10:30 am	Break (Coffee, Tea and Pastries)	South County
10:30 - 11:45 am	<p style="text-align: center;">Concurrent Symposia</p> <p style="text-align: center;">Symposium 4:</p> <p style="text-align: center;">Is Something Wrong with Generation X? Life-Span and Life-Course Approaches to Disparities in Health Outcomes: Theory, Method, Data Regarding Emerging Generational Differences in Happiness, Well-Being and Longevity</p> <p style="text-align: center;">Organized by Joseph Fitzgerald, Wayne State University</p> <p style="text-align: center;">Symposium 5:</p> <p style="text-align: center;">Relational Perspectives on the Roles that Adults, Friends, and Classrooms Play in Promoting Diversity and Minimizing Intergroup Bias</p> <p style="text-align: center;">Organized by Lacey J. Hilliard, Tufts University and Lynn S. Liben, The Pennsylvania State University</p> <p style="text-align: center;">Symposium 6:</p> <p style="text-align: center;">Perceptions of Learning and School Experiences from Early Childhood through Adolescence</p> <p style="text-align: center;">Organized by Susan Sonnenschein, University of Maryland Baltimore County and Yoko Yamamoto, Brown University</p>	<p style="text-align: center;">Bristol/Kent</p> <p style="text-align: center;">Newport/Washington</p> <p style="text-align: center;">Providence Ballroom</p>
11:45 - 1:15 pm	<p>Lunch Break</p> <p>Steering Committee Meeting</p>	Waterplace Ballroom

SATURDAY, OCTOBER 7th – Afternoon

1:15 - 2:45 pm	Plenary Symposium B: The Human-Nature Connection Organized by W. George Scarlett, Tufts University	Providence Ballroom
2:45 - 3:00 pm	Break	South County
3:00 - 4:15 pm	Keynote 4 - Presidential Address: Social Relations, Culture, Character Development and Health Kristine Ajrouch, Eastern Michigan University	Providence Ballroom
4:15 - 5:45 pm	Poster Session 2 (Cash Bar) Joseph Fitzgerald, Chair	Waterplace Ballroom
5:45 - 7:00 pm	Award Presentations, Membership Meeting and Reception (Hors d'oeuvres and Cash Bar)	Providence Ballroom
7:00 pm -	Outside Dinner	

SUNDAY, OCTOBER 8th – Morning

Time	Event	Room
8:00 am -	Registration	Providence Foyer
8:00 - 9:15 am	<p style="text-align: center;">Concurrent Symposia</p> <p style="text-align: center;">Symposium 7: Key Roles of Religiousness and Spirituality in the Context of Heart Failure Organized by Carolyn Aldwin, Oregon State University and Crystal Park, University of Connecticut</p> <p style="text-align: center;">Symposium 8: Character and Social-Emotional Development amount Early Adolescents: Results from Three School-Based Programs Organized by Jennifer Brown Urban, Montclair State University</p> <p style="text-align: center;">Symposium 9: Forgiveness and Humility: Life Course Processes and Adult Development Organized by Kristine Ajrouch, Eastern Michigan University and Toni Antonucci, University of Michigan</p>	<p style="text-align: center;">Bristol/Kent</p> <p style="text-align: center;">Newport/Washington</p> <p style="text-align: center;">Providence Ballroom</p>
9:15 - 9:30 am	Break (Coffee, Tea and Pastries)	South County
9:30 - 11:00 am	<p style="text-align: center;">Keynote 5: Spirituality and Thriving: Contemporary Investigations Pamela E. King, Fuller Theological Seminary</p>	Providence Ballroom
11:00 am - 12:15 pm	Lunch Break	Waterplace Ballroom

SUNDAY, OCTOBER 8th – Afternoon

12:15 - 1:30 pm	<p style="text-align: center;">Concurrent Symposia</p> <p style="text-align: center;">Symposium 10: Child and Adolescent Health and Wellbeing in China Organized by Ming Wen, University of Utah</p> <p style="text-align: center;">Symposium 11: Conceptualizations of the “Good Self;” Moral, Character, and Religious Aspects of Adolescents’ Identities Organized by Stacy Morris, Boston College</p> <p style="text-align: center;">Symposium 12: Discriminating, Eliminating, & Controlling: Investigating Health and Well-being Across the Lifespan Organized by Theresa Jackson, Bridgewater State University</p>	<p style="text-align: center;">Bristol/Kent</p> <p style="text-align: center;">Newport/ Washington</p> <p style="text-align: center;">Providence Ballroom</p>
1:30 - 1:45 pm	Break	South County
1:45 - 3:00 pm	<p style="text-align: center;">Plenary Symposium C: The Developmental Transition from Discrete Memories to an Integrated, Creative Web of Understandings Organized by Liane Gabora, University of British Columbia</p>	Providence Ballroom

SSHD Officers and Committees

Officers

President

Kristine Ajrouch
Eastern Michigan University

Past-President

Willis Overton
Temple University

President Elect

David Henry Feldman
Tufts University

Executive Secretary

Monika Ardelt
University of Florida

Treasurer

Rosemarie DiBiase
Suffolk University

Journal Editors

Megan McClelland
Oregon State University

Rick Settersten
Oregon State University

Web Site Editor

Anthony Dick
Florida International University

Listserv Manager

Denis Gerstorff
Humboldt University

Steering Committee

Kristine Ajrouch
Eastern Michigan University

Carolyn Aldwin
Oregon State University

Toni Antonucci
University of Michigan

Monika Ardelt
University of Florida

Michael Cunningham
Tulane University

Rosemarie DiBiase
Suffolk University

Anthony Dick
Florida International University

David Henry Feldman
Tufts University

Joseph Fitzgerald
Wayne State University

Denis Gerstorff
Humboldt University

Deborah Johnson
Michigan State University

Megan McClelland
Oregon State University

Chris Napolitano
University of Illinois

Rick Settersten
Oregon State University

Willis Overton
Temple University

Shannon Pruden
Florida International University

Jennifer Brown Urban
Montclair State University

Noah Webster
University of Michigan

Yoko Yamamoto
Brown University

Publications Committee

Joseph Fitzgerald (Chair)
Wayne State University

Toni Antonucci
University of Michigan

Kristine Ajrouch
Eastern Michigan University

Willis Overton
Temple University

Membership Committee

Shannon Pruden (Chair)
Florida International University

Anthony Dick
Florida International University

Activities Committee

Jennifer Brown Urban (Chair)
Montclair State University

John Geldhof
Oregon State University

Publicity Committee

Yoko Yamamoto, Chair
Brown University

Deborah Johnson
Michigan State University

Awards Committee

Toni C. Antonucci, Chair
University of Michigan

Carolyn Aldwin
Oregon State University

Emerging Scholars Committee

Chris Napolitano (Chair)
University of Illinois

Carla Abad
Florida International University

Veronica Barrios
Montclair State University

Lisa Chauveron
Montclair State University

Radosveta Dmitrova
Stockholm University

G. John Geldhof
Oregon State University

Parissa Jahromi
University of California San Francisco and
University of California Berkeley

Travis Marn
University of South Florida

Alan Meca
University of Miami

Rosalie Odean
Florida International University

Hunhui Oh
St. Ambrose University

Noah Webster
University of Michigan

Program Committee

David Henry Feldman
Tufts University

Chris Napolitano
University of Illinois

Joseph Fitzgerald, Chair
Wayne State University

Local Arrangements Committee

Yoko Yamamoto
Brown University

Mona Abo-Zena
University of Massachusetts, Boston

Accommodations

Omni Hotels & Resorts, Providence, Rhode Island Transportation, Restaurants, and Recreational Information

Closest Airports to Omni Hotel, Providence, RI:

The T. F. Green Airport is 15-20 minutes away. A second option is Boston-Logan International Airport, about 75 minutes away. There are a number of transportation options, available here: <http://www.dot.ri.gov/travel/>

If you choose to rent a car, Omni offers covered and secured parking. Driving directions and parking information can be found here:

<https://www.omnihotels.com/hotels/providence/property-details/directions>

Restaurants and Other Eating Options

There are a number of restaurants in walking distance or within a short cab ride of the hotel. Some of these are detailed here:

<https://www.zomato.com/providence>

Whether searching for a light breakfast from Morsel's, an elegant dinner at Fleming's Steakhouse or a romantic meal at Centro Restaurant, you will find just what you're craving at Omni Providence Hotel. These options are detailed here:

<https://www.omnihotels.com/hotels/providence/dining>

Recreational Activities in the Area

Whether you're looking for something fun to do close by or in the greater Providence area, we've compiled the best and most interesting events and attractions Providence has to offer.

Conference attendees can choose from a number of recreational activities, some of which are listed here:

<https://www.omnihotels.com/hotels/providence/things-to-do>

The following cities are also in driving distance of Providence:

- Newport (45 minutes Southeast)
- Boston (1 hour 30 minutes North)
- Cape Cod (1 hour 30 minutes East)

THIRD FLOOR

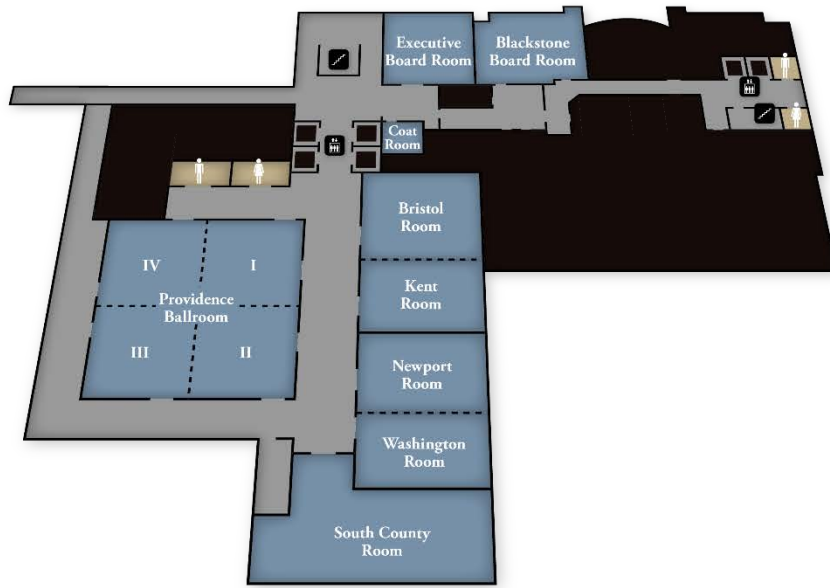

SECOND FLOOR

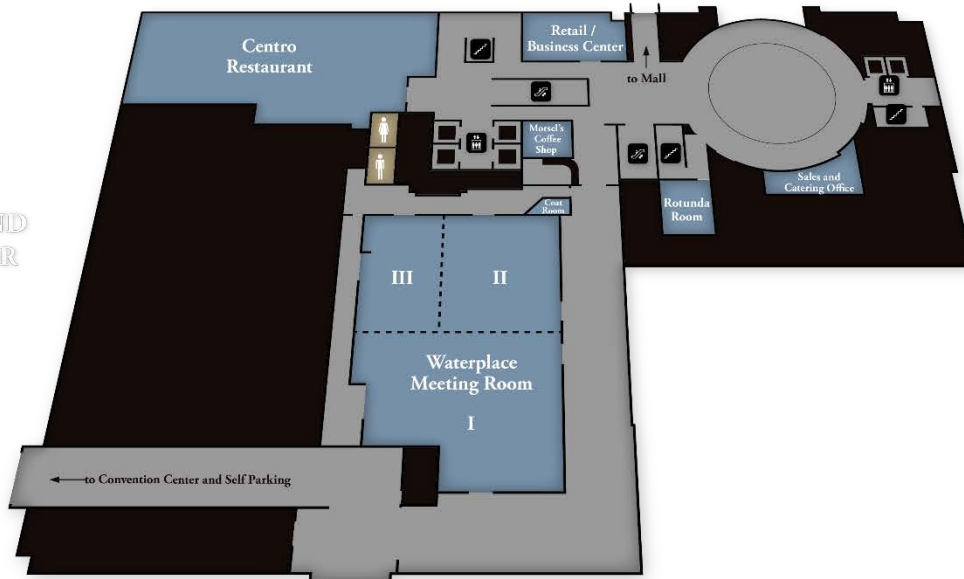

LOBBY

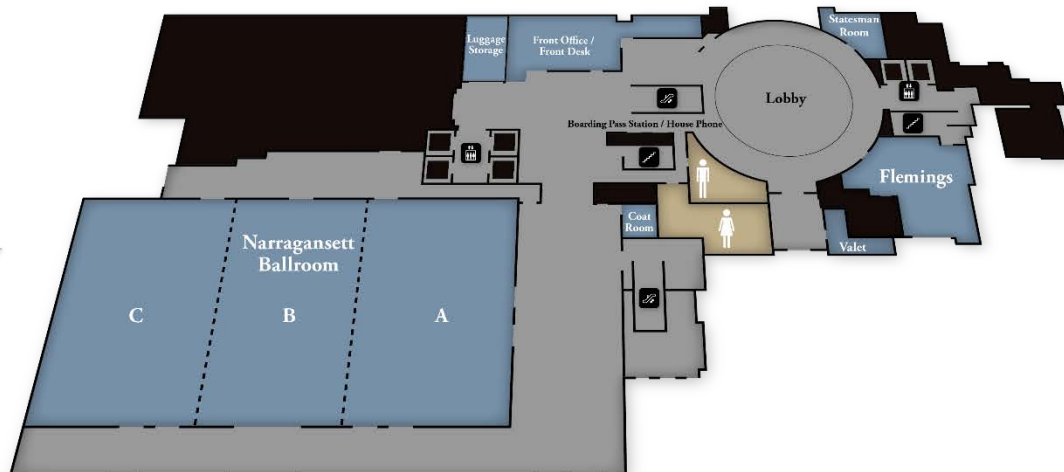

Keynote Addresses

1.) Spirituality and Health: Half a Million Studies and Still So Much to Learn!

Friday, October 6th, 2017, 9:15 - 10:30 am, Providence Ballroom

Crystal Park (University of Connecticut)



Crystal Park, Ph.D., is Professor of Clinical Psychology at the University of Connecticut, Storrs. She studies multiple aspects of coping with stressful events, including the roles of religious beliefs and religious coping, the phenomenon of stress-related growth, and the making of meaning in the context of traumatic events and life-threatening illnesses, particularly cancer and congestive heart failure. Dr. Park is currently conducting NIH-funded studies of yoga for stress management and self-regulation in persistence in university. She is Co-Editor of *The Handbook of the Psychology of Religion and Spirituality, 2nd Edition* (Guilford) and is co-author of the *Trauma, Meaning, and Spirituality: Translating Research In to Clinical Practice* (APA).

Abstract: In this plenary, I will review prevailing theoretical models of the links between spirituality and mental and physical health and summarize the current state of empirical literature regarding these links. Although many studies have already been conducted on relationships between spirituality and health, much remains unknown. I will describe what I see as particularly fruitful directions for future research and applications.

Keynote Addresses

2) Mod Squad for Youth Mental Health: Synthesizing Evidence-Based Interventions for Children and Adolescents

Friday, October 6th, 2017, 3:00 - 4:15 pm, Providence Ballroom

John Weisz (Harvard University)



John Weisz is Professor of Psychology in the Department of Psychology, Faculty of Arts and Sciences, Harvard University. He is also a Professor in Harvard Medical School. He leads the Harvard Lab for Youth Mental Health, developing and testing psychotherapy programs for mental health problems of children and adolescents. He also conducts meta-analyses describing and working to improve the science of youth mental health care. He has more than 300 publications, including ten books about child and adolescent mental health, and his work has generated more than 30,000 citations. He has received multiple scientific awards, including the *Klaus-Grawe*

Award for the Advancement of Innovative Research in Clinical Psychology and Psychotherapy, from the Klaus-Grawe Foundation, and the *James McKeen Cattell Lifetime Achievement Award* from the Association for Psychological Science—APS's highest honor—for work that "has had a profound impact on the field of psychological science over the past quarter century."

Abstract: Five decades of research have produced scores of empirically supported treatments (ESTs) for boys and girls who have emotional and behavioral problems. These ESTs—most focused on single disorders or problems (e.g., depression, disobedience)—have shown respectable effects in randomized trials in which treatment conditions are optimized for research. However, the ESTs do not fare as well when compared to usual clinical care with clinically referred young people in real-world service settings. One reason may be that referred youths are often more complex than the treatments designed to help them. Most youths referred for treatment have multiple problems and disorders, and their treatment needs shift over time. This challenge may be addressed by new treatment approaches that are flexible, personalizable, and multi-problem in scope. One example, the Child STEPs model, uses a modular treatment approach that combines tested intervention procedures for a range of different youth problems. Recent research with youths treated for anxiety, depression, post-traumatic stress, and conduct problems has found that Child STEPs works well, outperforming both treatment-as-usual and standard ESTs. Modular intervention may provide a bridge linking evidence on youth intervention to the complexity of real-world youth mental health care.

Keynote Addresses

3) Creativity is a Decision

Saturday, October 7th, 2017, 9:00 - 10:15 am, Providence Ballroom

Robert Sternberg (Cornell University)



Robert J. Sternberg, is currently a Professor in the Human Development department at Cornell University. He also served as IBM Professor of Psychology and Education at Yale University, Dean of Arts and Sciences at Tufts University, Provost at Oklahoma State University, and President of the University of Wyoming. Professor Sternberg has authored or edited dozens of books and hundreds of research publications, has received numerous grants and awards, and was President of the American Psychological Association (DRAFT)

Abstract: I will argue that creativity, rather than being an inborn trait, is rather a decision. It evolves from an attitude toward life that emphasizes the value of openness to new ideas, experiences, and products. Creative people are “defiers”: They are willing to defy the crowd, standing for what they believe in the face of many people who believe otherwise. They are willing as well to defy themselves, realizing that what they believe or act on at one time may change as time moves on; they do not let themselves get stuck in the “same old same old.” And they are willing to defy the Zeitgeist, or the common set of presuppositions we all hold without even realizing that we hold them. I will discuss what creativity is, how it can be measured in a domain-specific way, and how it can be developed in younger and older people alike. I will further suggest that our schools, in heavily emphasizing knowledge and critical skills, are doing a disservice to students and society by ignoring or even shunning the efforts they should be making to develop creativity in their students.

Presidential Address

4) Social Relations, Culture, Character Development and Health

Saturday, October 7th, 2017, 3:00 - 4:15 pm, Providence Ballroom

Kristine J. Ajrouch (Eastern Michigan University)



Kristine J. Ajrouch, PhD is Professor of Sociology at Eastern Michigan University, and Adjunct Research Professor in the Life Course Development Program at the Institute for Social Research, University of Michigan. Her research interests include cultural aspects of social relations over the life course. Her research has focused, for over 15 years, on Arab Americans in the U.S. beginning with ethnic identity formation among adolescent children of immigrants and more recently focusing on the experience of aging from the perspective of older adults in the metro-Detroit Arab American community. She recently completed a program of study concerning the topic of family ties and aging in Beirut, Lebanon following a Fulbright award in 2008. Professor Ajrouch also studies the topics of forgiveness and immigrant integration in comparative perspective.

Abstract: I will suggest that character development arises through various social encounters experienced over the life course. First, the concept of social relations is discussed as multi-dimensional and shaped by various cultural forces. Next, I consider how ethnicity, as a social construction, informs social relations. This will be followed by a presentation of population-level empirical data that investigates the direct and indirect ways in which social relations influence the character virtues of humility and forgiveness, and the ways this process varies by ethnicity. Links between character development and health will be presented to highlight both positive and negative effects. I will conclude with suggestions for future research and translational projects.

Keynote Addresses

5) Spirituality and Thriving: Contemporary Investigations

Sunday, October 8th, 2017, 9:30 - 11:00 am, Providence Ballroom

Pamela King (Fuller Theological Seminary)



Pamela Ebstyne King, the Peter L. Benson Associate Professor of Applied Developmental Science at the Thrive Center for Human Development in the School of Psychology at Fuller Theological Seminary, Pasadena, CA, researches and teaches in the areas of human thriving, spiritual and religious development, moral and character development, and theological perspectives on development. She received a B.A in Psychology from Stanford University and a Masters of Divinity and Ph.D. in Marital and Family Studies from Fuller Theological Seminary. Post-graduate studies were with the Divinity Faculty at Cambridge University and the Center on Adolescence at Stanford University. Pam is a co-author of *The Reciprocating Self: A Theological Perspective of Development* and co-editor of the *Handbook of Spiritual Development in Childhood and Adolescence*. Her research has been published in various journals such as *Developmental Psychology*, *Psychology of Religion and Spirituality*, *Applied Developmental Science*, *Journal of Early Adolescence*, and *The Journal of Psychology and Theology*.

Abstract: Although the founding fathers of psychology like James and Starbuck noted that religion and spirituality were seminal to being human, until the last few decades the study of these transcendent domains has been relegated to the sidelines of the study of human development. As research mounts evidence for the importance of religion and spirituality for thriving throughout the lifespan, scholars have begun to attend to the processes of spiritual and religious development. In order to highlight the importance of spirituality for thriving, the talk addresses current approaches to research on spiritual development and examines the potential developmental resources embedded within religion as a developmental context.

Invited Plenary Symposia

A) Reviewing what we may miss: Exploring regularities and variations in religion and spirituality across developmental processes, contexts, and outcomes

Friday, October 6th, 2017, 10:45 - 12:15 pm, Providence Ballroom

Organizer: Mona Abo-Zena (University of Massachusetts/Boston)

General Abstract: Although there has been a surge in scholarship on religion and spirituality, scholars and practitioners document longstanding gaps in understanding the role of religion and spirituality in developmental processes, contexts, and outcomes of diverse individuals in varied ecological contexts across the lifespan. While correlational studies and other research designs provide useful insights, such studies often fail to capture the robust and complex roles of spirituality in the lived experiences of children and adults and the interrelated manner in which spirituality and religion inform creativity, purpose, and physical and mental well-being. This plenary session highlights experiences from early childhood to adulthood in order to capture some of the overlooked beliefs, groups, and populations and to contribute to a holistic depiction of the role of religion and spirituality in human development. In particular, the session includes individuals representing diverse religious denominations and world traditions and levels of beliefs and practices, ranging from those who describe themselves as unaffiliated to those who identify as highly religious. The session features the frequently overlooked experiences of young children and fathers within the study of religious socialization and development, while including other key actors and factors. Looking closely at how practices affect developmental trajectories, the session attends to particular religious practices, religiously informed interventions, and the role of religion and spirituality within vulnerable and potentially empowering situations, such as coping with trauma. This session attends to understudied or minoritized religious, racial, and ethnic communities in the U.S. and internationally. The scholars discuss the diverse research methods that they draw from in order to creatively develop ecologically valid research, build more inclusive theory, and engage in applied work grounded in social justice. The plenary session ends with concluding comments and a brief period for questions and discussion.

Presenter 1: David Dollahite (Brigham Young University)

"Interactions Between Religious Socialization Practices and Relationship Processes in Diverse American Families"

Presenter 2: Hope Haslam Straughan (Wheelock College)

"Spirituality in the Lives of Children and Families: Perspectives from Justice-Based Social Work"

Presenter 3: Marino A. Bruce (Vanderbilt University)

"Evidence of Things Not Seen: The Relationship Between Faith and Health among Young African American Males"

Invited Plenary Symposia

B) The Human-Nature Connection

Saturday, October 7th, 2017, 1:15-2:45 pm, Providence Ballroom

Organizer: W. George Scarlett (Tufts University)

General Abstract: Decentering and interdependence have long been major themes for developmental scientists studying human development. However, these themes invariably have occurred in research focusing on human-to-human relationships. In this symposium, the focus shifts to human-nature relationships – and to the spiritual overtones that often accompany decentering with respect to nature and with respect to the experience of interdependence with nature. Mary Evelyn Tucker, co-founder and co-director of the Yale Forum on Religion and Ecology, Paul Waldau, leader in animal studies and animal law, and David Sobel, leader in environmental education, will explain the current thinking and current programs meant to bring us human animals into a more decentered and mindfully interdependent relationship with the natural world, one that puts us in a better position to change our current role as spoilers into that of stewards.

Presenter 1: Mary Evelyn Tucker (Yale University, School of Forestry and Environmental Studies, Divinity School and Department of Religious Studies)

“The Patterns that Connect: From the Streets to the Stars”

Presenter 2: Paul Waldau (Canisius College, Animal Behavior, Ecology, and Conservation/Anthrozoology)

“Speaking Plainly of Earth Stewardship and the Animal Question”

Presenter 3: David Sobel (Antioch University, Education Department, Antioch New England Graduate School)

“Bonding with the Earth in Middle Childhood: Why it's Not Happening and Why it's Important”

Discussant: W. George Scarlett (Tufts University, Eliot-Pearson Department of Child Study and Human Development)

Invited Plenary Symposia

C) The Developmental Transition from Discrete Memories to an Integrated, Creative Web of Understandings

Sunday, October 8th, 2-17, 1:45-3:00 pm, Providence Ballroom

Organizer: Liane Gabora (University of British Columbia)

General Abstract: In order for a child to become a contributing member of a society that exhibits cumulative, creative, cultural evolution, its knowledge and experiences must be woven into an *integrated* structure. Integrated cognition is necessary to form and understand analogies and metaphors, combine concepts, adapt ideas to new situations, make plans, prioritize, and reflect on situations so as to attain a multi-faceted understanding of them. In other words, to operate in the world in a characteristically human manner, the contents of a child's mind must *interact* so as to build a coherent web of understandings. However, here we face a dilemma. Knowledge and experiences become integrated by way of trains of thought, but trains of thought require associations amongst them (the 'tracks' upon which the trains run). How do you get one without the other? We have a chicken and egg problem. I will discuss a solution to this dilemma that I am developing with mathematician Mike Steel. Our model of how a child goes from discrete representations to integrated cognition uses a branch of graph theory originally applied to a similar paradox with the origin of life. We show the conditions under which, in our cognitive developmental application, items in memory surpass a critical 'percolation threshold' and self-organize into an associative network.

Presenter 1: Aparajita Ranjan (Yale University)

"Creativity self-regulation scale: Strategies for turning ideas into creative achievements"

Presenter 2: Zorana Ivcevic Pringle (Yale University)

"Creative process: From ideas to products and everywhere in between"

Presenter 3: Ronald Beghetto (University of Connecticut)

"Helping young people respond creatively to uncertainty"

Symposia

Symposium 1: Friday, October 6th, 2017, 1:30 - 2:45 pm, Bristol/Kent

Executive Function Across the Life-Span

Organizer: Megan McClelland (Oregon State University)

General Abstract: Executive function (EF) is a foundational set of skills that predict short- and long-term success across the life-span (McClelland et al., 2010). Most research, however, has examined EF in children or adults without a strong appreciation of how EF may look at different developmental periods. Moreover, measures to assess EF are often computer-based, time-intensive, and lack ecological validity. In addition, the same measures are rarely used with children and with adults. This symposium includes two papers from the USA and one paper from Iceland to examine EF in samples of children, adolescents, and older adults. Papers focus on issues related to measurement and relations between EF and key developmental outcomes.

Presentation 1: Claire E. Cameron (University at Buffalo), Helyn Kim (University of Virginia), Robert Duncan (University of California, Irvine), Derek Becker (Western Carolina University) Megan M. McClelland, Oregon State University
Title: Bidirectional and co-developing associations of cognitive and academic skills during kindergarten.

Presentation 2: G. John Geldhof (Oregon State University), Steinunn Gestsdóttir, & Freyja Birgisdóttir (University of Iceland)
Title: The relation between executive functions and intentional self-regulation in early adolescence: Implications for healthy development.

Presentation 3: Eric S. Cerino, Karen Hooker, Robert S. Stawski, & Megan McClelland (College of Public Health and Human Sciences, Oregon State University)
Title: Adapting the Head-Toes-Knees-Shoulders Task to Older Adults: A New Measure of Processing Speed, Attention, and Inhibitory Control.

Discussant: Anthony Dick (Florida International University)

Symposia

Symposium 2: Friday, October 6th, 2017, 1:30 - 2:45 pm, Newport/Washington

Religiosity, Spirituality, and Wisdom over the Life-Span

Organizer: Merrill Silverstein (Syracuse University)

Co-organizer: Monika Ardelt (University of Florida)

General Abstract: The papers presented in this symposium examine the dynamics of religiosity, spirituality, and wisdom at distinct stages of the lifespan. Together the presentations delve into issues relevant to the development and implications of these psycho-social constructs at opposite ends of the adult lifecycle. Two papers focus on late adolescence and early adulthood, with Ardelt studying interconnections among wisdom, spirituality, and health, and Bruya and Ardelt examining the efficacy of a wisdom training program. A paper by Ferrari et al. examines the role of wisdom in how young adults and older adults select, frame, and interpret the spirituality of exemplars of moral virtue. Finally, a paper by Silverstein, Bengtson, and Wang focuses on the evolution of altruistic or pro-social values over the later stages of life as older adults approach death. Together these papers portray temporal dynamism in the character of religiosity, spirituality, and wisdom, challenging assumptions about their immutability and localization at exclusive life-stages.

Presentation 1: Monika Ardelt (University of Florida)

Title: Do Daily Spiritual Experiences Make College Students Healthy and Wise or Are the Wise Healthier and More Spiritual? Investigating the Relations between Spirituality, Wisdom, and Subjective Health

Presentation 2: Woosang Hwang, Ayse Cakisory-Aslan, Merrill Silverstein, and Maria Brown (Syracuse University)

Title: Husband-Wife Religious Discordance and Marital Satisfaction: A longitudinal Investigation over 17 Years

Presentation 3: Merrill Silverstein¹, Vern L. Bengtson² & Rebecca Wang¹ (1Syracuse University, Department of Sociology and Aging Studies Institute, 2University of Southern California, School of Social Work)

Title: Patterns of Change in Values of Altruism with Aging and the Approaching End of Life

Presentation 4: Brian Bruya¹ & Monika Ardelt² (1Department of History and Philosophy, Eastern Michigan University, 2Department of Sociology and Criminology & Law, University of Florida)

Title: Wisdom in the Classroom: A Short-Term Longitudinal Study of Fostering Wisdom in a Traditional Higher Education Setting

Symposia

Symposium 3: Friday, October 6th, 2017, 1:30 - 2:45 pm, Providence Ballroom

Intra-individual Development Over Time: A Focus on Fathers and Families

Organizer: Toni Antonucci (University of Michigan)

General Abstract: This symposium aims to capture the subtlety of the father's influence on his children and other family members, examining both intra-individual change and inter-individual differences. Development over time is examined by focusing on father's social relations. Although research on fatherhood has increased, there is still much to learn about his role in the lives of children and families overall. Beyers-Carlson, et al. show how social relations in childhood change over time as children develop and assume the adult role of parent/father. Tighe and Davis-Kean consider the unique circumstance of fathers and mothers with high education and low income. These 'discordant' parents are most likely, but not universally likely, to have children who do better than other low income children, suggesting that paternal as well as maternal education can offer a protective influence for low income children. Fingerman, et al. examine fathers' relationship with their young adult children. While their findings suggest considerable differences in some details concerning interactions with children, most important forms of in-person contact, affection, companionship and support are similar to mothers. These papers indicate that the role of fathers in the lives of their children and families overall has been underestimated, perhaps because of the lack of rich father relevant data such as these. Brenda Volling (tentative) will serve as the discussant.

Presentation 1: Emma Beyers-Carlson, Jasmine Manalel, and Toni Antonucci (ISR, University of Michigan)

Title: Implications of parenthood for social networks

Presentation 2: Lauren A. Tighe (University of Michigan), Pamela E. Davis-Kean (University of Michigan)

Title: Low-income parents with college degrees: Investigating the relationship between parent gender, family characteristics, and child development

Presentation 3: Meng Huo, Karen L. Fingerman (University of Texas, Austin) and Kira S. Birditt (University of Michigan)

Title: Mothers, Fathers, Daughters, and Sons: Gender Differences in Adults' Intergenerational Ties.

Discussant: Discussant: Rob Palkovitz (University of Delaware)

Symposia

Symposium 4: Saturday, October 7th, 2017, 10:30-11:45 am, Bristol/Kent

Is Something Wrong with Generation X? Life-span and Life-Course Approaches to Disparities in Health Outcomes: Theory, Method, Data Regarding Emerging Generational Differences in Happiness, Well-Being and Longevity

Organizer: Joseph M. Fitzgerald (Wayne State University)

General Abstract: Persistent disparities in health and well-being in the United States due to gender, race, ethnicity, and geography have only recently drawn widespread attention among social scientists. Our symposium will focus on the important role for developmental scientists in this domain. Recent epidemiological research has identified a substantial reversal of decades long increases in life expectancy in nonhispanic white Americans (Case & Deaton, 2015). No other developed nation has shown a similar phenomenon. An excess of nearly 100,000 deaths took place between 1999 and 2013. The focal point of this change is the cohort of individuals referred to as Generation X, particularly those with lower education. Some have suggested that we rename Generation X as Generation Despair. The finding that the change is focused among those with less education, and that the causes of death involved (suicide, drug and alcohol poisoning, chronic liver diseases and cirrhosis) are behaviorally related suggests an important role for psychological research, most especially developmental psychology. Our symposium is designed to stake out the unique position of life-span and life-course approaches to conceptualize the roles of age, cohort, and time of measurement to this type of complex issue. The papers represent a balance of theoretical analysis and new data/analysis. A common theme is a focus on generational change and differences. In some cases, investigators may have data available to address these issues; in other cases we may use retrospective data to simulate development.

Presentation 1: Carolyn M. Aldwin & Soyoung Choun, (Center on Healthy Aging, College of Public Health, Oregon State University)

Title: Cohort Differences in Discrimination Stress and Mortality

Presentation 2: Jacqui Smith (Institute for Social Research, University of Michigan)

Title: Tracing Lives from High School to Midlife through a Period of Financial Instability

Presentation 3: Joseph M. Fitzgerald (Wayne State University)

Title: Regional and Cohort Differences in the Relationships among Perceived Psychosocial Development, Subjective Well-Being, and Responses to Stress, and Chronic Illness

Discussant. Richard Settersten (Oregon State University)

Symposia

Symposium 5: Saturday, October 7th, 2017, 10:30-11:45 am, Newport/Washington

Relational Perspectives on the Roles that Adults, Friends, and Classrooms Play in Promoting Diversity and Minimizing Intergroup Bias

Organizers: Lacey J. Hilliard (Tufts University) and Lynn S. Liben (The Pennsylvania State University)

General Abstract: Social-group membership influences the development of self-identity, the diversity of social experiences that individuals have with others, and life outcomes. It is not, however, only that individual lives are affected by the formation and persistence of social groups (e.g., those defined by gender, nationality, or ethnicity). It is also that social milieus in which individuals develop are themselves affected. Importantly, individual and contextual phenomena operate in, and are best understood by taking a relational—rather than a split—perspective (see Overton, 2015). Development takes place at the nexus of individuals and contexts. This symposium addresses conceptual, methodological, and empirical issues related to how social ingroups and outgroups are formed and maintained, and to how social stereotypes and intergroup behaviors are affected by adult socializing agents, peer friendships, and school structures. Presentations will cover, respectively, adults' beliefs about how social-group stereotypes and biases (e.g. racism, sexism) should be handled with children; the formation and consequences of friendships that cross social-group categories (e.g., race, gender); and how differing social-group school structures have consequences for individual children's beliefs and behaviors and for the broader classroom ecology. Drawing from an extensive program of prior scholarship, the discussant will place the three presentations within a general framework of relational analyses of human development.

Presentation 1: Lacey J. Hilliard (Tufts University), Lynn S. Liben (The Pennsylvania State University)

Title: Adults' Beliefs about How to Socialize Children about Social-Group Biases

Presentation 2: Rebecca S. Bigler & Amber Williams (The University of Texas at Austin)

Title: Antecedents and Consequences of Cross-Group Friendships in Children

Presentation 3: Lynn S. Liben (The Pennsylvania State University), Rebecca S. Bigler (The University of Texas at Austin) and Lacey J. Hilliard (Tufts University)

Title: Social-group Divisions in Classrooms: Effects on Individual Children and the Broader Ecology

Discussant. Willis F. Overton (Temple University)

Symposia

Symposium 6: Saturday, October 7th, 2017, 10:30-11:45 am, Providence Ballroom

Perceptions of Learning and School Experiences from Early Childhood through Adolescence

Organizers: Yoko Yamamoto (Brown University) and Susan Sonnenschein (University of Maryland, Baltimore)

General Abstract: Beliefs about learning and schooling serve to guide students' learning attitudes and their academic achievement. Ample evidence has demonstrated diverse beliefs related to learning and education depending on cultural, ethnic, and immigrant contexts. However, little is known about how students themselves perceive their learning and school experiences during different developmental periods. This panel will present four studies focusing on perceptions of learning and school experiences by students from early childhood through adolescence in diverse cultural and ethnic contexts. The four presentations will include issues such as young Japanese children's personal- and interpersonal-oriented perceptions related to the purposes of school learning, elementary children's views of executive function strategies and their related cognitive and behavioral skills, Chinese American youth's perceptions of learning as mutual obligations with their parents, and children's and adolescents' perceived school-based discrimination and its impacts on their learning and wellbeing. Implications of these perceptions on students' educational experiences and outcomes will also be discussed.

Presentation 1: Yoko Yamamoto and T. Heywood (Brown University) & S. Hosokawa (AmeriCorps)

Title: Young Children's Perceptions of School Learning in Japan: Socioeconomic and Cultural Comparisons

Presentation 2: Susan Sonnenschein, Simons, C. L., & Metger, S. R. (University of Maryland, Baltimore)

Title: Elementary School-Aged Children's Knowledge of How They Learn

Presentation 3: Bempechat, J. (Wheelock College), Cheung, A. (Harvard Graduate School of Education), & Li, J. (Brown University)

Title: A Foucauldian Discourse Analysis of Educational Messaging in Four Chinese American Youth

Presentation 4: Marks, A. K. (Suffolk University), & Ejese, K. (Boston Children's Hospital)

Title: School-Based Discrimination and Its Impact on Child Learning

Symposia

Symposium 7: Sunday, October 8th, 2017, 8:00 - 9:15 am, Bristol/Kent

Key Roles of Religiousness and Spirituality in the Context of Heart Failure

Organizers: Crystal Park (University of Connecticut) and Carolyn Aldwin (Oregon State University)

General Abstract: We are conducting a longitudinal project on religion/spirituality (R/S) and mental and physical health in older adults with congestive heart failure (CHF). This project, funded by the Templeton Foundation and the National Institute on Aging, was designed to examine how dimensions of R/S influence health and well-being in people dealing with a high-mortality illness. CHF is a progressive, life-limiting illness that diminishes life quality and adversely affects many aspects of well-being. We assessed self-reported spirituality and health (two waves separated by six months) in 170 older adults living with CHF and then followed up on this sample five years later to examine physical health and mortality in the sample. Our initial work found that a form of spirituality, inner peace, was associated with lower mortality risk (Park et al., 2016). In this symposium, we present the results of this project in three separate studies that follow up on that finding in various ways.

Presentation 1: Crystal L. Park, Lauren M. Carney & Ian Gutierrez (University of Connecticut) and Carolyn M. Aldwin (Oregon State University)

Title: Religious beliefs predict mental and physical health in older adults with CHF

Presentation 2: Soyoung Choun, Hyunyup Lee & Carolyn M. Aldwin (Center on Healthy Aging, College of Public Health, Oregon State University) and Crystal L. Park (University of Connecticut)

Title: Spiritual Peace and Religiousness in Congestive Heart Failure Patients

Presentation 3: Carolyn Aldwin & Soyoung Choun (Center on Healthy Aging, College of Public Health, Oregon State University) and Crystal Park (University of Connecticut)

Title: Do Ejection Fractions Mediate between Spirituality and Mortality in Congestive Heart Patients?

Discussant: Monika Ardelt (University of Florida)

Symposia

Symposium 8: Sunday, October 8th, 2017, 8:00 - 9:15 am, Newport/Washington

Character and Social-Emotional Development among Early Adolescents: Results from Three School-Based Programs

Organizer: Jennifer Brown Urban (Montclair State University)

General Abstract: Youth today have the potential to be active, engaged, contributing members of civil society if provided with appropriate and much needed support from peers, families, and schools. Character and social-emotional development programs that specifically focus on helping youth to identify and reflect on positive personal values and transform those values into meaningful, sustained action hold tremendous promise for avoiding the pitfalls of adolescence and producing a generation of youth who demonstrate moral fortitude and thrive in today's complex, global world. Inspire Aspire: Global Citizens in the Making, Thriving Learning Communities, and MOSAIC are school-based character development programs targeting middle-school aged youth that have demonstrated success. Character and social-emotional development programs such as these have the potential to help adolescents develop essential life skills. In this symposium, these three programs will be described and evidence regarding their efficacy will be discussed.

Presentation 1: Jennifer Brown Urban & Miriam R. Linver (Montclair State University), Sara K. Johnson (Tufts University)

Title: Association between Pupil Outcomes and Variations in Teacher Implementation of a Character Development Program

Presentation 2: Karen Graves (Mayerson Academy), Robert E. McGrath (Fairleigh Dickinson University)

Title: Thriving Learning Communities: Achieving Social-Emotional Learning through the Language of Character Strengths

Presentation 3: Maurice J. Elias, Samuel J. Nayman (Rutgers University)

Title: Purpose, Values, and Skills: Connecting Character Education and Social-Emotional Learning in a Multi-Year, School-Wide, Middle School Intervention

Discussant: Sarah Clement (John Templeton Foundation)

Symposia

Symposium 9: Sunday, October 8th, 2017, 8:00 - 9:15 am, Providence Ballroom

Forgiveness and Humility: Life Course Processes and Adult Development

Co-Organizers: Kristine Ajrouch (Eastern Michigan University) & Toni Antonucci (University of Michigan)

General Abstract: We are living in difficult times, earmarked by hostility, aggression, intolerance and hate. The growing prevalence of these characteristics has dire consequences for the health and well-being of our society. In this symposium, we focus on the characteristics of humility and forgiveness as important vehicles for neutralizing the seemingly ever-escalating negative attributes of modern society and moving us towards a more positive personal and societal trajectory. A better and more complete understanding of how these attributes develop and can be fostered in individuals is a critical first step to addressing major world problems. Humility is a highly valued virtue, and forgiveness is often defined as a pro-social response to a hurtful situation. We target humility and forgiveness because they are uniquely associated with positive group relations as well as better health and well-being. This symposium aims to provide a rigorous examination of life course processes that shape development (or aspects) of forgiveness and/or humility, or the outcomes associated with aspects of forgiveness and/or humility. These papers represent cutting-edge research in the scientific study of humility and forgiveness. We anticipate that this collection of papers will bring together diverse research on the topics forgiveness and humility as a life course process. The focus on adult development will be useful for guiding future research and interventions designed specifically to understand and increase forgiveness and humility across the life span. Our ultimate goal is to contribute to improvements in the quality of both individual and societal well-being.

Presentation 1: Toni Antonucci (University of Michigan), Kristine Ajrouch (Eastern Michigan University), Kira Birditt and Noah Webster (University of Michigan)

Title: Social Relations, Interpersonal Resources and Health: Trust, Efficacy and Forgiveness

Presentation 2: Noah J. Webster (University of Michigan), Kristine J. Ajrouch (Eastern Michigan University), Toni C. Antonucci (University of Michigan)

Title: Sociodemographic Differences in Humility: The Role of Social Relations

Presentation 3: Noel A. Card (University of Connecticut)

Title: Meta-analyses of the Reliabilities of Measures of Forgiveness and Humility

Discussant: Richard Bollinger (John Templeton Foundation)

Symposia

Symposium 10: Sunday, October 8th, 2017, 12:15 - 1:30 pm, Bristol/Kent

Child and Adolescent Health and Wellbeing in China

Organizer: Ming Wen (University of Utah)

General Abstract: Since the beginning of 1979, China's reform and opening era has generated miraculous economic growth turning China from a poor and isolated country to a major economic player in the globalized world. Concomitantly, China has also experienced a massive rural-to-urban internal migration, likely the largest in human history. Hundreds of millions of adults have moved from rural areas to urban areas for economic opportunities and over 90 million children of migrants are affected. The patterns of and factors shaping child development in the face of rural-to-urban migration and growing socioeconomic inequalities in China have become a central area of social science inquiry.

Presentation 1: Jingxuan Wang & Lei Jin (Chinese University of Hong Kong) and Ming Wen (University of Utah)

Title: Neighborhood social contexts and adolescent mental health in China

Presentation 2: Zhi Ye¹ (1Institute of Developmental Psychology, Beijing Normal University), Ming Wen, (University of Utah), Danhua Lin¹, and Weidong Wang, (Renmin University of China)

Title: Perceived relative income and positive youth development in China: The mediating role of school social capital

Presentation 3: Li He¹ (College of Physical Education and Sports, Beijing Normal University), Ming Wen (University of Utah) and Danhua Lin (Institute of Developmental Psychology, Beijing Normal University)

Title: Lifestyle disparities between local and migrant children in Beijing, China

Presentation 4: Jessie Fan, Ming Wen & Neng Wan (University of Utah)

Title: The role of multilevel economic resources in multiple developmental outcomes among early adolescents in China

Symposia

Symposium 11: Sunday, October 8th, 2017, 12:15 - 1:30 pm, Newport/Washington

Conceptualizations of the “Good Self:” Moral, Character, and Religious Aspects of Adolescents’ Identities

Organizer: Stacy Morris (Boston College)

General Abstract: Identity development is an important issue facing adolescents as they mature (e.g., Erickson, 1959). Adolescents may think about identity-related questions such as the occupation they want to pursue (e.g., Vondracek, 2009), the role they want religion to play in their lives (e.g., Hardy & Carlo, 2011), and the types of relationships that are important to them (e.g., McElwain et al., 2015). Many young people also think about what it means to them to be a good person and how that relates to their identity development. The papers in this symposium represent different perspectives on incorporating aspects of what it means to be “good” as part of the identity development process. Together, our four papers explore the many facets of youth identity development related to being a good person and point to many directions for future research.

Presentation 1: Hardy, S. (Brigham Young University)

Title: The integration of moral identity, religious identity, and identity maturity

Presentation 2: Shubert, J. (University of Rochester), Wray-Lake, L. (University of California, Los Angeles), Metzger, A. (West Virginia University) and Syvertsen, A. (Search Institute)

Title: Character Strengths, civic engagement, and academic competencies: The mediating role of character centrality

Presentation 3: MacDonnell, M., Linver, M.R., Urban, J.B. and Samtani, S. (Montclair State University)

Title: Ideal self, goal setting, and expectations of success: Applying Eccles’ Expectancy Value Model to a sample of Scottish youth

Presentation 4: Morris, S.L., (Boston College) Johnson, S.K. (Tufts University) and Aymong, C. (Boston College)

Title: Standing up for what you believe in: Moral identity, self regulation, and adolescents’ moral courage

Symposia

Symposium 12: Sunday, October 8th, 2017, 12:15 - 1:30 pm, Providence Ballroom

Discriminating, Eliminating, & Controlling: Investigating Health and Well-being Across the Lifespan

Organizer: Theresa Jackson (Bridgewater State University)

General Abstract: From a lifespan perspective, healthy development involves passage through challenges and opportunities, from conception until old age. A sociocultural approach to lifespan development operates under the assumption that individuals cannot be isolated from the context, culture, and domains in which development occurs. Driven by the intersection of these approaches, the current panel will present four papers exploring how health and well-being are affected by various socio-cultural processes during childhood, emerging adulthood, and at various points during the adult lifespan.

Presentation 1: Marcelo, A.K. (Clark University)

Title: Child Experiences of Discrimination and Later Health and Well-Being

Presentation 2: Jackson, T.E. (Bridgewater State University)

Title: "I LOVE This": Women's Attitudes Toward Menstrual Suppression and Reproductive Health

Presentation 3: Faherty, A., & Arnett, J.J. (Clark University)

Title: Mind Games: Parental Psychological Control and Emerging Adults' Well-Being

Presentation 4: Mitra, D., & Arnett, J.J. (Clark University)

Title: Subjective Life Assessment and Well-being Across the Adult Lifespan

Poster Sessions

Poster Session #1

Friday, October 6th, 4:15 - 5:45 pm, Waterplace Ballroom

1)	Nora Obregon Whittier College. "Examining Play and Literacy Development in Latino Children and their Older Siblings"
2)	Christine Ohannessian University of Connecticut School of Medicine and Anna Vannucci Connecticut Children's Medical Center. "Does Adolescent Psychological Functioning Predict Membership in Latent Adolescent-Parent Communication Dual Trajectory Classes?"
3)	Anna Vannucci Connecticut Children's Medical Center, Christine Ohannessian University of Connecticut School of Medicine, Sonja Gagnon, Victoria Galica and Ashley Raynock Connecticut Children's Medical Center. "Adolescent Overweight and Obesity Predicts Anxiety in Emerging Adulthood"
4)	Kathleen Robinson Tufts University. "Do student perceptions of the school environment change after participation in a joint media experience? Searching for positive outcomes of children's media use in schools"
5)	Corey Boothe and Marianna Linz Marshall University. "Investigation of Factors Contributing to the Development of Digital Nativity as an Identity in Rural and Urban Students"
6)	Kerrie Pieloch Suffolk University, Mary Beth McCullough Brown University and Amy Marks Suffolk University. "Body Image Satisfaction, Assimilation, and Health of Immigrant Adolescents: A Person-Centered Analysis"
7)	Stephanie Santos and Kathleen H. Corriveau Boston University. "Explanatory coexistence in explaining events within the Latino community"
8)	Michael Lamport Commons ¹ , Sagun Giri ² and William Joseph Harrigan ³ ¹ Harvard Medical School, ² The Pennsylvania State University & ³ Harvard University. "There is only one stage domain"
9)	Michael Lamport Commons ¹ and Shuling Julie Chen ² ¹ Harvard Medical School, ² New York University. "Advances in the Model of Hierarchical Complexity"
10)	Michael Lamport Commons Harvard Medical School. "What are the relationships between four notions of stage change?"
11)	Noel Card University of Connecticut. "A Meta-Analysis of the Psychometric Properties of Three Commonly Used Measures of Creativity"
12)	Ashley Shimmel, Wanny Pimentel and Grant Greco Suffolk University. "Tipping the Self Esteem Scale: The Role of Gender, Gender Role, & Social Media"
13)	Anthony Burrow, Jennifer Agans, Hee Jin Jeon and Michael Creim Cornell University. "In Defense of Darth Vader: Uncloaking the Substance and Significance of Purpose Content"
14)	Sarah Coburn, Stephanie Maskell, Jessica Pappagianopoulos, Jolie Straus and Kathryn Cantrell Tufts University. "A Systematic Review of Medical Support Interventions For Pediatric Patients with Autism Spectrum Disorder"

15)	Sharon Head University of New Mexico. "Shaped by story: One teacher's reflection on memory and text as a tool for understanding how to better serve students with behavioral and/or cognitive differences"
16)	Shelby Clark and Allen G. Harbaugh Boston University. "The role of teaching students to ask their own questions for promoting student curiosity, cognitive engagement, and self-efficacy: Explorations through path modeling"
17)	Anna Vannucci Connecticut Children's Medical Center, Christine Ohannessian University of Connecticut School of Medicine, Kaitlin Flannery University of Connecticut and Sonja Gagnon Connecticut Children's Medical Center. "Disentangling the Temporal Relationship Between Body Image Dissatisfaction and Anxiety Symptoms in Adolescents Using Cross-Lagged Models"
18)	Amanda Siegel and Yoko Yamamoto Brown University. "Attributions of Academic Success in Parents of First Grade Students in the United States: A Mixed Method Approach"
19)	Courtney Lincoln University of Connecticut, Victoria Galica and Christine Ohannessian Connecticut Children's Medical Center. "Family Satisfaction Mediates the Relationship between Adolescents' Emotion Dysregulation and Global Self-worth"
20)	Jessica Matthews, Xian Zhang and Ellen Pinderhughes Tufts University. "Patterns of Adoptive Family Socialization and Bias Experiences across Development and Family Characteristics"
21)	Stephanie Maskell and Yichen Zhu Tufts University. "Impact of Sibling Relationship on Alcohol Use for Adolescents with Well and Asthmatic Siblings"
22)	Deanna Ibrahim New York University, Meriah DeJoseph New York University, Amanda Roy University of Illinois- Chicago and Cybele Raver New York University. "Adolescents take action: A look into the experiences that inform the development of critical consciousness among low-income minority youth"
23)	Elaine Barry The Pennsylvania State University, Fayette. "What Mothers Believe about Co-sleeping and What the Research Shows: A Review"
24)	Shufang Dong University of Rochester. "Calling for socio-psycho literacy"
25)	Kingsley Schroeder and Lynn S. Liben The Pennsylvania State University. "A Mixed-Methods Approach to Understanding Developmental Trends in Metacognitions of Gender"
26)	Rachel Oblath and Jennifer Greif Green Boston University. "Diversity in Youth Bullying Victimization Experiences: Power Imbalance and Type of Victimization"
27)	John McKenna Suffolk University, Katherine Bedard-Thomas Cincinnati Children's Hospital and Amy Marks Suffolk University. "Sexuality-related social support among girls: The moderating role of minority identity label endorsement"
28)	Patrece Joseph, Jessica Pappagianopoulos and Sasha Fleary Tufts University. "Too Much Information, Little Guidance: Adolescents' Perception of Using Health Literacy to Manage their Health"
29)	Patrece Joseph and Sasha Fleary Tufts University. "More than Media: Examining Collective Efficacy in the Association Between Adolescent Media Use and Obesity"

30)	Jessica Pappagianopoulos, Patrece Joseph and Sasha Fleary Tufts University. "The Relationship between Screen Time and Obesity among Adolescents with Special Health Care Needs: Understanding the Role of Preventive Health Services"
31)	Kalpana Miriyala Joan C. Edwards School of Medicine at Marshall University, Lucas-Adkins Conrae, Marianna Linz, Adrienne Creel and Corey Boothe Marshall University. "Outcomes for children prenatally exposed to opioids: A retrospective study"
32)	Amy Mace and Claire Cameron University at Buffalo. "The Development of Theory of Mind over Time"
33)	Amy Mace and Claire Cameron University at Buffalo. "Kindergarteners' Initial Social Problem-Solving Skills Predict the Relationship They Develop With Their Teacher"
34)	Christopher M Napolitano University of Illinois at Urbana Champaign and Alexandra M Freund University of Zurich. "Are there age-related differences in the use and usefulness of backup plans?"
35)	Ashley Trinh Frank H. Netter School of Medicine, Quinnipiac University and Christine Ohannessian Connecticut Children's Medical Center, UConn School of Medicine. "The Associations Between Self-Competence and Depression Symptoms in Late Adolescence: An Examination of Gender Differences"
36)	Seoyoung Lim Tufts University, Amber Landers Cambridge Health Alliance/Harvard Medical School and Sophie Simkin Tufts University. "Integrating Bias Awareness and Reflection into Early Childhood Consultation: Evaluation of the Early Years Project Programs"
37)	Kelly Nedorostek, Anna Vannucci and Christine McCauley Ohannessian Connecticut Children's Medical Center. "Social Media Use and Depression Symptoms in Emerging Adults"
38)	Deborah Johnson Michigan State University, Barbara Thelamour College of Wooster, Sudha Sankar Michigan State University and Radosveta Dimitrova Stockholm University. "Reframing the narrative: Revealing positive youth development in the self-descriptions of Roma adolescents"
39)	Kneia Dacosta Ursinus College. "We interrupt these messages by bringing you a program: advertising media literacy education in middle schools"
40)	Kneia Dacosta, Alexzandria Luben and Stephanie Gardner Ursinus College. "From dodging "bullets" to building shields: a working model for resisting Macro- and micro-aggressions"
41)	Alison Bane, Michelle B. Weiner and Jacqueline V. Lerner Boston College. "Virtue Development in Adolescence: An Exploration of Spirituality and Character Strengths in Catholic School Students"
42)	Grace Lozano and Allison Dibianca Fasoli Middlebury College. "Creating Autonomous Moral Selves through Parent-Child Conversations in a Religiously Liberal Protestant Community"

Poster Session #2

Saturday, October 7th, 4:15 - 5:45 pm, Waterplace Ballroom

1)	Sarah Erwin and Julie Tippens University of Nebraska-Lincoln. "The Pathway to Resilience: Factors Leading to Wellbeing among Elder Refugees"
2)	Seojung Jung SUNY Old Westbury and Daniela Jopp University of Lausanne. "Role Model of Successful Aging Among Asian Americans"
3)	Christine Ohannessian and Sonja Gagnon Connecticut Children's Medical Center. "Video Game Play and Anxiety during Adolescence: The Moderating Effects of Gender and Social Context"
4)	Janet Macneil Vroomen Yale School of Medicine and Joan Monin Yale School of Public Health. "The effects of unmet needs on quality of life in persons with dementia and their informal-caregivers using Actor-Partner Interdependence Model"
5)	Tonia Bock, Kristina Klein, Jayna Lundgren, Courtney Pelissero and Brityn Ryshavy University of St. Thomas. "Moral identity and generativity across adulthood"
6)	Stephanie Shackelford Student at Northeastern University; Founder of Student Launch Pad. "Development of a Career Calling for Emerging Adults"
7)	Eleanor Fisk and Allison Dibianca Fasoli Middlebury College. "Socialization of emotion regulation in early childhood classrooms"
8)	Masahiro Toyama and Heather Fuller North Dakota State University. "Longitudinal Stress-Buffering Effects of Social Integration in Late-Life Physical Health"
9)	Nicholas Palumbo University of Rochester and Brandon Gaylord Harvard Graduate School of Education. "StandUp Leadership: A Qualitative Investigation of Adolescent Self-Perceptions of Leadership Identity Development"
10)	Jennifer Agans Cornell University. "You don't know what you can do until you try: A study of physical activity at summer camp"
11)	Rebecca Olson, Amy Knepple Carney and Julie Hicks Patrick West Virginia University. "Associations between Gratitude and Spirituality: An Experience Sampling Approach"
12)	Denise Kyte and Rosemarie Dibiase Suffolk University. "Attachment, Theory of Mind, and Temperament-derived Reactivity as Predictors of Maternal and Peer Acceptance in Pre-Schoolers"
13)	Julia Choi and Yoko Yamamoto Brown University. "Childrearing Values in Japan and the United States"
14)	Masami Takahashi Northeastern Illinois University, Kobo Matsushima and Ayaka Kasuga University of Tokyo. "The Impact of Parents' Religious Faith on the Understanding of Spirituality among their adult Children: A Comparison of Japanese Buddhists, Christians, and the Non-Religious"
15)	Joan Monin Yale School of Public Health, Janet MacNeil-Vroomen Yale School of Medicine, Richard Schulz University of Pittsburgh, Margaret Doyle & Terrence Murphy Yale School of Medicine and Diane Ives University of Pittsburgh. "Time-varying Perceived Social Support and Older Adults' Survival in The Cardiovascular Health Study"

16)	Pamela King Fuller Theological Seminary, Jonathan Tirrell Tufts University, Caitlin Aymong, Michelle Weiner, Courtnye Lloyd and Jacqueline Lerner Boston College. "Spirituality and Hopeful Future Expectations: Measuring Spiritual Development in El Salvador Youth"
17)	Noradilah Md Nordin & Peter Martin Iowa State University and Mansor Abu Taib Universiti Putra Malaysia. "Neuroticism, Daily Hassles and Mental Health among Undergraduate Students in Malaysia"
18)	E-Shien Chang and Joan Monin Yale University. "Existential Suffering and Health in Older Couples"
19)	Deanna Ibrahim, Meriah DeJoseph and Cybele Raver New York University. "Emotional Go/No-Go in the field: Applying a lab-based standard measure of emotional regulation to a high-poverty adolescent population"
20)	Karen Hussar Pine Manor College. "The Great Divide: Assessing Children's Moral Judgment-Moral Action Gap regarding Environmental Issues"
21)	Sherrell House North Carolina Agricultural and Technical State University. "Examining Adaptive Behaviors as Resistance Strategies for African American College Students in Adverse University Contexts"
22)	Michael Cunningham and Antanious White Tulane University. "Religiosity, Prosocial Values, and Future Expectations in High-Achieving Urban African American Adolescents"
23)	Alex Wheeler and Rosemarie Dibiase Suffolk University. "Early Parenting Sensitivity and the Development of Externalizing Behaviors: Executive Function and Negative Affectivity as Potential Mediators"
24)	Nikolas Lunny University of Massachusetts, Dartmouth, Sarah Cerrone Boston University and Aminda O'Hare University of Massachusetts, Dartmouth. "Mindfulness Meditation Interventions Reduce Negative Affect in Two School Samples"
25)	David Bachoy & Kaitlin Flannery University of Connecticut and Christine Ohannessian Connecticut Children's Medical Center. "Associations Between Marijuana Use and Time Spent Playing Different Types of Video Games Alone and with Others"
26)	Lia O'Brien West Chester University, Yue Liang and Jonathan Tudge University of North Carolina at Greensboro. "Gratitude in Parents and Children"
27)	William Chopik Michigan State University and Hannah Giasson University of Michigan. "Geographic Variation in Age Bias: Contextual Fit Predicts Subjective Age Estimates"
28)	Christina Morton University of Michigan. "Examining the Role of Spirituality in Promoting Black Collegians' Resilience in Historically White Institutions"
29)	Jessie Quintero Johnson and Jennifer Gregg University of Massachusetts Boston. "Mediated Life Transitions: Portrayals of Mental Health Across the Lifespan"
30)	Xupin Zhang and Silvia Sorensen University of Rochester. "Examining Older Adults' Consumer Behavior from a Life Course Perspective"
31)	Elsa Bravo, Rosalie Odean, Jessica Bartley, Emily Boeving, Jennifer Foreman & Ariel Gonzalez Florida International University, Eric Brews Drexel University, Angela Laird and Shannon Pruden Florida International University. "Do spatial activity experiences influence spatial anxiety?"
32)	Anne Conway Columbia University. "Longitudinal links between maternal cognitive stimulation during toddlerhood and preschool neuro cognition: The moderating role of attention focusing and fearful temperament"

33)	Daniela Alvarez, Carla Abad and Shannon Pruden Florida International University. "The Relationship Between Stereotype Threat, Spatial Anxiety, and Mental Rotation Performance"
34)	David Henry Feldman and Amelia Andrews, Tufts University. "Cultural Evolution Is Not Evolution"
35)	Barrett Scroggs Kansas State University, Jason Miller University of Kansas and M. Hunter Stanfield Kansas State University. "Identity development and reconciliation of religious identities in gender and sexual minority emerging adults"
36)	Antanious White, Zachary Bondy and Michael Cunningham Tulane University. "Religious Support as a buffer between Negative Youth Experiences and Challenging Attitudes in African American Adolescent Males"
37)	Karin Bakracevic Vukman & Barbara Krpan University of Maribor and Voyko Kavcic Institute of Gerontology, Wayne State University. "Congruence between self-evaluated and actual cognitive abilities during late adulthood"
38)	Jennifer Leszczynski Eastern Connecticut State University. "Love Wisdom? A Cross-sectional Study of Love and Romance"
39)	Monika Ardelt University of Florida, Andreas Fischer Forschungsinstitut Betriebliche Bildung, Justine E. Owens and Margaret Plews-Ogan University of Virginia. "Personality and Wisdom"
40)	Sara Rakes Eastern Michigan University. "Tensions Between Modernity and Tradition: A Comparison of Catholic and Muslim Communities"
41)	Mariah Contreras, Melissa Colon, Katie Aasland and Jayanthi Mistry Tufts University. "Understanding complexity in self-identification of race and ethnicity among young mothers in varying sociocultural contexts"

Author Index

K=Keynote Address;

IPS=Invited Plenary Symposium

S=Symposium

P=Poster

A

Aasland, Katie

katie.aasland@tufts.edu

P-2(41)

Abad, Carla

cabad003@fiu.edu

P-2(33)

Abo-Zena, Mona

mona.abozena@umb.edu

IPS-A

Agans, Jennifer

P. jenagans@gmail.com

m

P-1(3), P-2(10)

Ajrouch, Kristine J.

kajrouch@emich.edu

K-4, S-9

Aldwin, Carolyn M.

carolyn.aldwin@oregonstate.edu

S-4, S-7

Alvarez, Daniela

dalva132@fiu.edu

P-2(33)

Andrews, Amelia

amelia.andrews@tufts.edu

P-2(34)

Antonucci, Toni

C. tca@umich.edu

S-3, S-9

Ardelt, Monika

ardelt@ufl.edu

S-2, P-2(39)

Arnett, J. J.

jarnett@clarku.edu

S-12

Aymong, Caitlin

aymong@bc.edu

P-2(16)

B

Bachoy, David

david.bachoy@uconn.edu

P-2(25)

Bakracevic-Vukman, Karn

karin.bakracevic@um.si

P-2(37)

Bane, Alison

baneal@bc.edu

P-1(41)

Barry, Elaine

esb12@psu.edu

P-1(23)

Bartley, Jessica

jbart047@fiu.edu

P-2(31)

Becker,

Derek drbecker@email.wcu.edu

S-1

Bedard-Thomas,

Katherine katie.bedard@gmail.com

P-1(27)

Beghetto, Ronald

ronald.beghetto@uconn.edu

IPS-C

Bengtson, Vern

bengtson@usc.edu

S-2

Bempechat, Janine

jbempechat@wheelock.edu

S-6

Beyers-Carlson, Emma

ebcarlso@umich.edu

S-3

Bigler, Rebecca, S.

rebeccabigler28@gmail.com

S-5

Birditt, Kira

kirasb@umich.edu

S-3, S-9

Birgisdóttir, Freyja

freybi@hi.is

S-1

Bock, Tonja

tsbock@stthomas.edu

P-2(5)

Boeving, Emily

eboev001@fiu.edu

P-2(31)

Bollinger,

Richard rbollinger@templeton.org

S-9

Bondy, Zachary

zbondy@tulane.edu

P-2(36)

Boothe, Corey

boothe27@live.marshall.edu

P-1(5)

Bravo, Elsa

ebrav012@fiu.edu

P-2(31)

Brewe, Eric

eric.brewe@gmail.com

P-2(31)

Brown, Maria

mbrown08@syr.edu

S-2

Bruce, Marino A.

marino.bruce@vanderbilt.edu

IPS-A

Bruya, Brian

bbruya@emich.edu

S-2

Burrow, Anthony



Author Index

K=Keynote Address;
IPS=Invited Plenary Symposium
S=Symposium
P=Poster

C

Cakisory-Aslan, Ayse Duygu
adcakirs@syr.edu

S-2

Cameron, Claire
cecamero@buffalo.edu

S-1, P-1(32), P-1(33)

Cantrell, Kathryn
kathryn.cantrell@gmail.com

P-1(14)

Card, Noel
noel.card@uconn.edu

S-9, P-1(11)

Carney, Amy Knepple
amknepplecarney@mix.wvu.edu

P-2(11)

Carney, Lauren,
M. lauren.m.carney@uconn.edu

S-7

Cerino, Eric, S.
cerinoe@oregonstate.edu

S-1

Cerrone, Sarah
scerrone@bu.edu

P-2(24)

Chang, E-Shien
eshien@gmail.com

P-2(18)

Chen, Shuling Julie
shulingjuliechen@gmail.com

P-1(9)

Cheung, Amy
amc078@mail.harvard.edu

S-6

Choi, Julia
julia_choi@brown.edu

Chopik, William J.
chopik@umich.edu

P-2(27)

Choun, Soyounng
Soyounng.choun@oregonstate.edu

S-4, S-7

Clark, Shelby
sclark2@bu.edu

P-1(16)

Clement, Sarah
sclement@templeton.org

S-8

Coburn, Sarah
sarah.coburn@tufts.edu

P-1(14)

Colon, Melissa
melissa.colon@tufts.edu

P-2(41)

Commons, Michael Lampion
commonsmc@gmail.com

P-1(8), P-1(9), P-1(10)

Conrae, Lucas-Adkins
lucas26@marshall.edu

P-1(31)

Contreras, Mariah
mariah.contreras@tufts.edu

P-2(41)

Conway, Anne
ac3292@columbia.edu

P-2(32)

Corriveau, Kathleen, H.
kcorriv@bu.edu

P-1(7)

Creel, Adrienne
creel6@marshall.edu

P-1(31)

Cunningham, Michael
mcunnin1@tulane.edu

P-2(22), P-2(36)

D

DaCosta, Kneia
kdacosta@ursinus.edu

P-1(39), P-1(40)

Davis-Kean, Pamela, E.
pdakean@umich.edu

S-3

Dejoseph, Meriah
meriah.dejoseph@nyu.edu

P-1(22), P-2(19)

DiBiase, Rosemarie
rdibiase@suffolk.edu

P-2(12)

Dick, Anthony
adick@fiu.edu

S-1, P-2(23)

Dimitrova, Radosveta
radosveta.dimitrova@gmail.com

P-1(38)

Dollahite, David
david_dollahite@byu.edu

IPS-A

Dong, Shugang
shufangd14@gmail.com

P-1(24)

Doyle, Margaret
margaret.doyle@yale.edu

P-2(15)

Duncan, Robert
duncanrj@uci.edu

S-1



E

Ejesi, K.

[email](mailto:kjesi@middlebury.edu)

S-6

Fleary, Sasha

sasha.fleary@tufts.edu

P-1(28), P-1(29), P-1(30)

Giri, Sagun

sagunppgiri@gmail.com

P-1(8)

Author Index

K=Keynote Address;

IPS=Invited Plenary Symposium

S=Symposium

P=Poster

Elias, Maurice J.

Rutgersmje@aol.com

S-8

Foreman, Jennifer

jforeman@fiu.edu

P-2(31)

Gonzalez, Ariel

ariegonz@fiu.edu

P-2(31)

Erwin, Sarah

erwin1sc@gmail.com

P-2(1)

Freund, Alexandra M.

freund@psychologie.uzh.ch

P-1(34)

Graves, Karen

graves.karen@mayersonacademy.org

[academy.org](http://www.mayersonacademy.org)

S-8

F

Fan, Jessie

fan@fcs.utah.edu

S-10

Fuller, Heather

heather.fuller@ndsu.edu

P-2(8)

Greco, Grant

mgreco@suffolk.edu

P-1(12)

Faherty, Amanda

afaherty@clarku.edu

S-12

G

Gabora, Liane

liane.gabora@ubc.ca

IPS-C

Green, Jennifer Greif

jggreen@bu.edu

P-1(26)

Fasoli, Allison Dibanca

adibiancafasoli@middlebury.edu

P-1(42), P-2(7)

Gagnon, Sonja

SGagnon@connecticutchildrens.org

P-1(3), P-1(17), P-2(3)

Gregg, Jennifer

jennifer.gregg@umb.edu

P-2(29)

Feldman, David H.

davidhenry.feldman@tufts.edu

P-2(34)

Galica, Victoria

VGalica@connecticutchildrens.org

P-1(3), P-1(19)

Gutierrez, Ian

ian.gutierrez@uconn.edu

S-7

Fingerman, Karen L.

kfingerman@austin.utexas.edu

S-3

Gardner, Stephanie

stgardner@ursinus.edu

P-1(40)

H

Harbaugh, Allen

harbaugh@bu.edu

P-1(16)

Fischer, Andreas

fischer.andreas@f-bb.de

P-2(39)

Gaylord, Brandon

brandon_gaylord@gse.harvard.edu

P-2(9)

Hardy, Sam

sam_hardy@byu.edu

S-11

Fisk, Eleanor

efisk@middlebury.edu

P-2(7)

Geldhof, John

john.geldhof@oregonslate.edu

[tate.edu](http://www.oregonslate.edu)

S-1

Harrigan, William Joseph

williamjosephharrigan@gmail.com

P-1(8)

Fitzgerald, Joseph M.

aa1670@wayne.edu

S-4

Gestsdóttir, Steinunn

steinuge@hi.is

S-1

He, Li

aprilhelly@bjmu.edu.cn

S-10

Flannery, Kaitlin

kaitlin.flannery@uconn.edu

P-1(17), P-2(25)

Giasson, Hannah L.

giasson@umich.edu

P-2(27)

Head, Sharon

shead2018@unm.edu

P-1(15)



Heywood, T.

[email](#)

S-6

Jin, Lei

ljin@cuhk.edu.hk

S-10

barbara.krpan1@gmail.com

P-2(37)

Author Index

K=Keynote Address;

IPS=Invited Plenary Symposium

S=Symposium

P=Poster

Hilliard, Lacey J.
lacey.hilliard@tufts.edu
S-5

Hooker, Karen
hookerk@oregonstate.edu
S-2

Hosokawa, S.
[email](#)
S-6

House, Sherrell
shhouse@ncat.edu
P-2(21)

Huo, Meng
mhuo@austin.utexas.edu
S-3

Hussar, Karen
khussar@pmc.edu
P2-(20)

Hwang, Woosang
hwoosang@syr.edu
S-2

I

Ibrahim, Deanna
dai231@nyu.edu
P-1(22), P-2(19)

Ives, Diane
ivesd@edc.pitt.edu
P-2(15)

J

Jackson, Theresa
theresaejackson@gmail.com
S-12

Jeon, Hee Jin
heejinjeon6@gmail.com
P-1(13)

Johnson, Deborah J.
john1442@msu.edu
P-1(38)

Johnson, Jessie Quintero
jessie.quintero@umb.edu
P-2(29)

Johnson, Sara K.
s.johnson@tufts.edu
S-8, S-11

Jopp, Daniela
daniela.jopp@unil.ch
P-2(2)

Joseph, Patrece
patrece.joseph@tufts.edu
P-1(28), P-1(29), P-1(30)

Jung, Seojung
jungs@oldwestbury.edu
P-2(2)

K

Kasuga, Ayaka,
yxg7qfjvc9bxmbjehyr5@gmail.com
P-2(14)

Kavcic, Voyko
voykok@gmail.com
P-2(37)

Kim,
Helyn helynk@gmail.com
S-1

King, Pamela E.
pamking@fuller.edu
K-5, P-2(16)

Klein, Kristina
klei0003@stthomas.edu
P-2(5)

Krpan, Barbara

Kyte, Denise
dkyte@suffolk.edu
P-2(12)

L

Laird, Angela
alaird@fiu.edu
P-2(31)

Landers, Amber
alanders@challiance.org
P-1(36)

Lee, Hyunyup
leehyuny@onid.oregonstate.edu
S-7

Lerner, Jacqueline V.
lernerj@bc.edu
P-1(41), P-2(16)

Leszczynski, Jennifer
leszczynskij@easternct.edu
P-2(38)

Li, Jin
jin_li@brown.edu
S-6

Liang, Yue
y_liang@uncg.edu
P-2(26)

Liben, Lynn S.
liben@psu.edu
S-5, P-1(25)

Lim, Seoyoung
limseoyoung0831@gmail.com
P-1(36)

Lin, Danhua
[email](#)
S-10

Lincoln, Courtney



courtney.lincoln@uconn.edu
P-1(19)

amarcelo@clarku.edu
S-12

P-2(35)

Miriyala, Kalpana
miriyala@marshall.edu
P-1(31)

Author Index

K=Keynote Address;
IPS=Invited Plenary Symposium
S=Symposium
P=Poster

Linver, Miriam R.
linver@montclair.edu
S-8, S-11

Linz, Marianna
linz@marshall.edu
P-1(5), P-1(31)

Lloyd, Courtney
lloydcb@bc.edu
P-2(16)

Lozano, Grace
glozano@middlebury.edu
P-1(42)

Luben, Alexandria
alluben@ursinus.edu
P-1(40)

Lundgren, Jayna
lund0192@stthomas.edu
P-2(5)

Lunny, Nikolas
nlunny@umassd.edu
P-2(24)

M

MacDonnell, Marisa
macdonnellm1@mail.montclair.edu
S-11

MacNeil-Vroomen, Janet
janet.macneilvroomen@yale.edu
P2-(4), P-2(15)

Mace, Amy
amymace@buffalo.edu
P-1(32), P-1(33)

Manalele, Jasmine
jmanalele@umich.edu
S-3

Marcelo, A. K.

Marks, Amy
akmarks@suffolk.edu
S-6, P-1(16), P-1(27)

Martin, Peter
pxmartin@iastate.edu
P-2(17)

Maskell, Stephanie
stephanie.maskell@tufts.edu
P-1(14), P-2(21)

Matsushima, Kobo
kobo@yf6.so-net.ne.jp
P-2(14)

Matthews, Jessica
jessica.matthews@tufts.edu
P-1(20)

McClelland, Megan
megan.mcclelland@oregonstate.edu
S-1

McCullough, Mary Beth
marybeth.mccullough@gmail.com
P-1(6)

McGrath, Robert, E.
mcgrath@fdu.edu
S-8

McKenna, John
jmckenna2@suffolk.edu
P-1(27)

Metger, S. R.
email
S-6

Metzger, Aaron
Aaron.Metzger@mail.wvu.edu
S-6

Miller, Jason
jmm045@ku.edu

Mistry, Jayanthi,
jayathi.mistry@tufts.edu
P-2(41)

Mitra Deeya
dmitra@clarku.edu
S-12

Monin, Joan
joan.monin@yale.edu
P-2(4), P-2(15), P-2(18)

Morris, Stacy L.
morrispx@bc.edu
S-11

Morton, Christina
cspr@umich.edu
P-2(28)

Murphy, Terrence
terrence.murphy@yale.edu
P-2(15)

N

Napolitano, Christopher
cmnapolitano@gmail.com
P-1(34)

Nayman, Samuel J.
samuelnayman@gmail.com
S-8

Nedorostek, Kelly
nedorostek@uchc.edu
P-1(37)

Nordin, Noradilah
dila@iastate.edu
P-2(17)

O

O'Brien, Lia
ltobrien@uncg.edu
P-2(26)



Oblath, Rachel
roblath@bu.edu
P-1(26)

Patrick, Julie Hicks
jpatric2@wvu.edu
P-2(11)

Robinson, Kathleen
kathleen.robinson@tufts.edu
P-1(4)

Author Index

K=Keynote Address;
IPS=Invited Plenary Symposium
S=Symposium
P=Poster

Obregon, Nora
nobregon@whittier.edu
P-1(1)

Pelissero, Courtney
pele0004@stthomas.edu
P-2(5)

Roy, Amanda
alroy28@uic.edu
P-1(22)

Odean, Rosalie
rosalieodean@gmail.com
P-2(31)

Pieloch, Kerrie
kapieloch@suffolk.edu
P-1(6)

Ryshavy, Brityn
rysh0003@stthomas.edu
P-2(5)

O'Hare, Aminda
aohare@umassd.edu
P-2(24)

Pimentel, Wanny
wpimentel@suffolk.edu
P-1(12)

S
Samtani, Satabdi
samtanis@mail.montclair.edu
S-11

Ohannessian, Christine
COhannessian@connecticutchildrens.org
P-1(2), P-1(3), P-1(17), P-1(19),
P-1(35), P-1(37), P-2(3), P-2(25)

Pinderhughes, Ellen
ellen.pinderhughes@tufts.edu
P-1(20)

Santos, Stephanie
stephss3@bu.edu
P-1(7)

Olson, Rebecca
reolson@mix.wvu.edu
P-2(11)

Plews-Ogan, Margaret
MP5K@hscmail.mcc.virginia.edu
P-2(39)

Sankar, Sudha
sankarsu@msu.edu
P-1(38)

Overton, Willis F.
overton@temple.edu
S-5

Pringle, Zorana Ivcevic
zorana.ivcevic@yale.edu
IPS-C

Scarlett, W. George
george.scarlett@tufts.edu
IPS-B

Owens, Justine
JEO8N@hscmail.mcc.virginia.edu
P-2(39)

Pruden, Shannon M.
sdick@fiu.edu
P-2(31), P-2(33)

Schroeder, Kingsley
kms676@psu.edu
P-1(25)

P
Palkovitz, Robert
robp@udel.edu
S-3

Park, Crystal L.
crystal.park@uconn.edu
K-1, S-7

Palumbo, Nicholas
npalumb2@u.rochester.edu
P-2(9)

Pappagianopoulos, Jessica
jessica.pappagianopoulos@tufts.edu
P-1(14), P-1(28), P-1(30)

Q
R
Rakes, Sara
srakes1@emich.edu
P-2(40)

Ranjan, Aparajita
apara.ranjan@yale.edu
IPS-C

Raver, Cybele
cybele.raver@nyu.edu
P-2(19)

Raynock, Ashley
araynock@springfieldcollege.edu
P-1(3)

Schulz, Richard
schulz@pitt.edu
P-2(15)

Scroggs, Barrett
barretts@ksu.edu
P-2(35)

Settersten, Richard
A. richard.Settersten@oregonstate.edu
S-4

Shackelford, Stephanie
shackelford.s@husky.neu.edu
P-2(6)



Shimmel, Ashley
ashimmel@suffolk.edu
P-1(12)

hstraughan@wheelock.edu
IPS-A

Tudge, Jonathan
jrtudge@uncg.edu
P-2(26)

Straus, Jolie
Jolie.Straus@tufts.edu
P-1(14)

Author Index

K=Keynote Address;
IPS=Invited Plenary Symposium
S=Symposium
P=Poster

Shubert, Jennifer
jennifer.shubert@rochester.edu
S-11

Siegel, Amanda
amanda_siegel@brown.edu
P-1(18)

Silverstein, Merrill
merrills@syr.edu
S-2

Simkin, Sophie
sophiesimkin@gmail.com
P-1(36)

Simons, C. L.
csimons1@umbc.edu
S-6

Smith, Jacqui
smitjacq@umich.edu
S-4

Sobel, David
dsobel@antioch.edu
IPS-B

Sonnenschein, Susan
sonnensc@umbc.edu
S-6

Sorensen, Silvia
ssorensen@warner.rochester.edu
P-2(30)

Stanfield, M. Hunter
mhstanfield@ksu.edu
P-2(35)

Stawski, Robert S.
Robert.Stawski@oregonstate.edu
S-1

Straughan, Hope Haslam

Sternberg, Robert
rjs487@cornell.edu
K-3

Syvertsen, A.
amys@search-institute.org
S-11

T
Taib, Mansor Abu
mansorat@upm.edu.my
P-2(17)

Takahashi, Masami
m-takahashi@neu.edu
P-2(14)

Thelamour, Barbara
bthelamour@wooster.edu
P-1(38)

Tighe, Lauren A.
tighelau@umich.edu
S-3

Tippens, Julie
jtippens@unl.edu
P-2(1)

Tirrell, Jonathan
M. jonathan.tirrell@tufts.edu
u
P-2(16)

Toyama, Masahiro
masahiro.toyama@ndsu.edu
P-2(8)

Trinh, Ashley
ATrinh@connecticutchildrens.org
P-1(35)

Tucker, Mary Evelyn
maryevelyn.tucker@yale.edu
IPS-B

U
Urban, Jennifer B.
urbanj@mail.montclair.edu
S-8, S-11

V
Vannucci, Anna
AVannucci@connecticutchildrens.org
P-1(2), P-1(3), P-1(17), P-1(37)

W
Waldau, Paul
waldaup@canisius.edu
IPS-B

Wan, Neng
neng.wan@utah.edu
S-10

Wang, Jingxuan
jingxuan@hku.hk
S-10

Wang, Rebecca
rwang09@syr.edu
S-2

Wang, Weidong
wwd@ruc.edu.cn
S-10

Webster, Noah J.
njwebs@umich.edu
S-9

Weiner, Michelle
weinermd@bc.edu
P-1(41), P-2(16)

Weisz, John
john_weisz@harvard.edu
K-2

Wen, Ming



ming.wen@soc.utah.edu

S-10

Author Index

K=Keynote Address;

IPS=Invited Plenary Symposium

S=Symposium

P=Poster

Wheeler, Alex

awheeler2@suffolk.edu

P-2(23)

White, Antanious

awhite23@tulane.edu

P-2(22), P-2(35)

Williams, Amber

adaionewilliams@gmail.com

S-5

Wray-Lake, Laura

wraylake@luskin.ucla.edu

S-11

X

Y

Yamamoto, Yoko

Yoko_Yamamoto@brown.edu

S-6, P-1(18), P-2(13)

Ye, Zhi

yezhipsy@163.com

S-10

Z

Zhang, Xian

xian.zhang@tufts.edu

P-1(20)

Zhang, Xupin

xzhang72@u.rochester.edu

P-2(30)

Zhu, Yichen

yichen.Zhu@tufts.edu

P-1(21)